

D22x9.1 Series

Day
Night

22x

D22x9.1R2D-V41

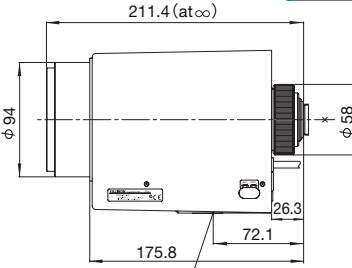
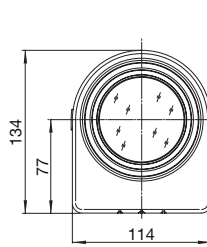

Applicable camera (model) 1 2/3 1/2 1/3 1/4

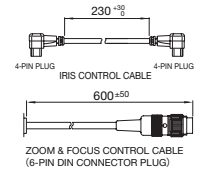

Unit : mm

Zoom MOTOR DRIVE WIDE TELE VIDEO C-mt METAL PRESET ND F1.2 RoHS Compliant
-Y41

TRIPOD ATTACHING SCREW (1/4-20 UNC)

	Applicable to 1/2	Applicable to 1/2	Applicable to 1/2
	D22x9.1B-S41	D22x9.1B-Y41	D22x9.1R2D-V41
Focal Length (mm)		9.1 - 200(22x)	
Iris Range		F1.2 - T1500(Equivalent to F1500)	
Operation	Zoom	Motor Drive	
	Focus	Motor Drive	
Iris	Auto(Video Type)		Auto(Video Type) or Remote*1
Angle Of View (H×V)	1/2" WIDE TELE	38° 45' × 29° 33'	
Focusing Range (From Front Of The Lens) (m)		∞ - 3	
Object Dimensions at M.O.D.(H×V) (mm)	1/2" WIDE TELE	2034 × 1526	
Back Focal Distance (in air) (mm)		93 × 69	
Exit Pupil Position (From Image Plane) (mm)	23.93		24.05
Filter Thread (mm)	-676	M82 × 0.75	-672
Mass (kg)	2.3		2.5
Wiring Diagram	P26		P25

* 1 : For details on the Iris-Remote connection, see the relevant Technical Reference (Page 28).

Y12x6A Series

12x

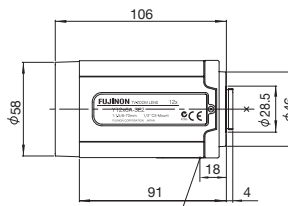
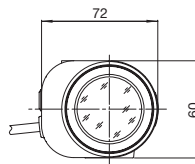

Applicable camera (model) 1 2/3 1/2 1/3 1/4

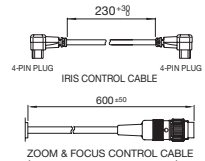

Unit : mm

Zoom MOTOR DRIVE WIDE TELE DC CS-mt METAL PRESET ND F1.5 RoHS Compliant
-YE2

TRIPOD ATTACHING SCREW (1/4-20 UNC)

	Applicable to 1/3	Applicable to 1/3
	Y12x6A-SE2	Y12x6A-YE2
Focal Length (mm)		6 - 72(12x)
Iris Range		F1.5 - T400(Equivalent to F400)
Operation	Zoom	Motor Drive
	Focus	Motor Drive
Iris	Auto(DC Type)*1	
Angle Of View (H×V)	1/3" WIDE TELE	43° 36' × 33° 24'
Focusing Range (From Front Of The Lens) (m)		∞ - 1.3
Object Dimensions at M.O.D.(H×V) (mm)	1/3" WIDE TELE	1003 × 753
Back Focal Distance (in air) (mm)		84 × 63
Exit Pupil Position (From Image Plane) (mm)		11.69
Filter Thread (mm)		-6028
Mass (g)	330	M55 × 0.75
Coil Resistance		350
Current Consumption		Drive Coil 180 Ω Damping Coil 720 Ω
Wiring Diagram		22mA (Max.) at DC 4V P23

* 1 : When power is turned off, iris will automatically close.