



by **Schneider** Electric

# Spectra IV

Camera Positioning Systems



## Get More With Four. Spectra IV.

You know it by name. It's been a cornerstone of security installations over the last decade. It's demanded in the highest-profile jobs around the world. And it just keeps getting better. The Pelco Spectra IV Camera Positioning System is the latest in a long line of products under the Spectra name, and like its predecessors, it continues to set the industry standard for innovation and performance.



# The Ultimate Positioning System.



Spectra IV is the definitive piece of any security installation, offering industry-leading features specifically designed and engineered to enhance the safety of people, property and assets.

## Unmatched Performance

The flagship Spectra IV SE 35X model takes the business of image capture to a whole new level. With an industry-leading 35X optical zoom lens, 540 TV lines of resolution and an amazingly low .00018 lux sensitivity, Spectra IV is focused on delivering the crispest, most-detailed video possible. Moreover, special consideration was taken to achieve an optimal optical relationship between the lens and the bubble, ensuring crystal-clear video at long focal lengths.

## Wide Dynamic Range Capabilities

Spectra IV's enhanced Wide Dynamic Range (WDR) capability, available in 23x and 35x systems, compensates for those scenes where dynamic contrasts in lighting are present, resulting in useable video regardless of glare, direct sunlight or shadows. Thanks to these and other optics innovations, the Spectra IV SE camera positioning system is the ideal choice for any and all lighting conditions.

## Low Light Conditions

The Spectra IV 35x and 18x systems, and SE's 23x camera/optics package feature automatic cut filter removal for Day/Night operation that provides high-quality color images by day and higher sensitivity black-and-white images at night. Digital Slow Shutter (DSS) is a technology that enhances the low-light performance of a camera, producing outstanding images in low-light conditions. DSS increases the camera's sensitivity and is available in all Spectra IV systems. And with IR Trace Curves for proper focus at your choice of 850 or 950 nanometer wavelengths, Spectra IV captures what others miss.

## Image Stabilization

An advanced Electronic Image Stabilization algorithm, available in all 35x systems, helps prevent the image from blurring due to vibrations caused by external sources such as wind or traffic. Built-in Motion Detection (23x and 35x systems) provides excellent security responsiveness. And as with all Spectra IV systems, its Integrated Scheduler lets you pre-program Patterns, Presets, Alarms and Relays, turning your Spectra IV SE system into an automated security force.



Powerful Optics

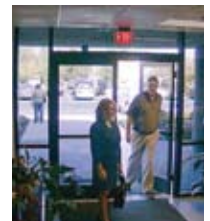

The Clearest Video



Day or Night Operation



Electronic Image Stabilization



### Fast Pan

Spectra IV's variable speed capabilities range from a smooth, fast pan motion of 400 degrees per second to a smooth "creep" speed of 0.1 degrees per second. The system is capable of continuous 360-degree rotation and has an "auto flip" feature that allows the dome to rotate 180 degrees and reposition itself for uninterrupted viewing of any subject that passes directly beneath it. Optional diagnostic/installation tools (IPS-RMK and IPS-CABLE) allow the installer to view video, control PTZ and perform system setup and software upgrades at the installation site.

### Remote Monitor

Accessing video and camera system settings through the RJ-45 port is fast and easy. Simply connect the optional Remote Monitor Kit and you will be able to view video, control PTZ functions and perform setup and system upgrades at the installation site. No more going back and forth from your dome to the monitor to make sure all adjustments are made. The Remote Monitor Kit combines a battery-powered 5.6-inch TFT LCD color monitor and a PDA preloaded with the necessary software – all packaged in a portable, compact carrying case.

### Powerful Connectivity

First and foremost, every Spectra IV model comes standard with an integrated UTP circuit located on the door assembly for convenient video transmission. This built-in capability allows security installations to take advantage of existing cabling infrastructure to provide a effective, yet low-cost medium for transmission. Additionally, PelcoFiber modules can also be attached for transmission over single- or multi-mode fiber. A wide selection of optional TXB protocol translator boards are also available, including the TXB-IP, which turns the Spectra IV into a true IP-based, network camera positioning system.

### Back-Box Memory

System components are interchangeable with all other Spectra systems, and each Spectra IV SE back-box model features back-box memory to store camera and location-specific dome settings, including Labels, Patterns, Presets, Scheduler Events and Zones. Now, retrofits and application adjustments are easier than ever.



For Any Application



Easy to Install and Configure



Multiple Communications Options



Unparalleled Design



With powerful advances in optics technology to capture crystal-clear video, unmatched reliability and installations made easier than ever, Spectra IV sets the standard for positioning systems.



An aerial photograph of a university campus. In the foreground, a large, paved plaza with a complex, winding path is filled with many people walking. The plaza is interspersed with green lawns, young trees in circular planters, and a circular concrete structure. In the background, several large, modern university buildings with large windows and flat roofs are visible, set against a backdrop of rolling hills and a clear sky. A large, semi-transparent blue rectangular box is overlaid on the left side of the image, containing white text.

Spectra IV continues to be the industry's only truly modular positioning system, giving you unprecedented flexibility to build a system that meets the specific demands of your next installation.

# Spectra IV IP. This Changes Everything.



An IP-based camera positioning system with the features, responsiveness, and reliability of the most trusted name in the industry, Spectra IV IP has been specifically designed for the stringent – and unique – demands of video security.

Truly understanding what today's security professionals demand from security products and technologies, Spectra IV IP camera positioning systems meet and exceed the rigorous demands of security applications. With its seamless integration into all video security applications, Spectra IV IP delivers first-of-its-kind, simultaneous IP/analog functionality.

## Simultaneous IP and Analog Functionality

Spectra IV IP is an advanced network-based camera positioning system designed as an edge appliance for deployment in any number of security applications. Delivering three simultaneous IP streams, bi-directional, full duplex audio and high-quality, real-time video (4CIF at 30 IPS), today's security professionals can view and control the industry's leading camera positioning system from virtually anywhere in the world.

Understanding the critical nature of security installations, Pelco designed Spectra IV IP with simultaneous analog control. And that means zero latency. Move the joystick and the camera system pans, tilts and zooms at a moment's notice. For those mission-critical installations when people, objects and events must be accurately and smoothly tracked, the dual functionality of Spectra IV IP places it a step above all others.

Moreover, this simultaneous IP/analog functionality provides system redundancy. In the event, for example, of a network failure, analog control remains, enabling security personnel to continue to access the dome for both viewing and control.

## Open Architecture

Based on an open architecture, Spectra IV IP works with all the popular IP protocols and third-party manufacturers are already developing API documentation in order to bring it into network-based applications.

Spectra IV IP seamlessly integrates with the Digital Sentry product line and is also Endura-Enabled to record, manage, configure and view multiple live streams. When used in such applications, Spectra IV IP has access to EnduraStor and EnduraView for optimized image quality and bandwidth efficiency.

## Spectra IV IP Product Features

- Control and Monitor Network Video and Audio Over IP
- Three Simultaneous Video Streams: Dual MPEG-4 at 30 images per second and Scalable MJPEG
- Supported Protocols: TCP/IP; UDP/IP (Unicast, Multicast IGMP); UPnP; DNS; DHCP, RTP, NTP
- Multilevel Password Protection
- Five Autofocus, High-Resolution Integrated Camera/Optics Packages
- Day/Night, 540 TVL, 128x WDR, Motion Detection and Electronic Image Stabilization (SD4N35 Series)





# Spectra IV Tough.



There are many reasons why Spectra IV is proving to be the most reliable, most trusted camera positioning system in the world. Spectra IV systems are built upon the experience and knowledge of more than 20 years of industry-leading dome system design and manufacturing.

Because of Pelco's firm belief in integrated manufacturing, we maintain control of every design, every process, and every component that gets built into Spectra IV systems. Every process is analyzed and tested to ensure the longest life and best performance possible. From Accelerated Life and Stress Testing, to real-world application and installation testing, nothing is left to chance.

## Pelco Testing Regime Includes

- Water Ingress Resistance
- Corrosive Environment Resistance
- Ultraviolet Resistance
- Impact Resistance
- Extreme Temperature Operation
- Voltage/Surge Tolerance
- Motion and Vibration Resistance
- Extensive Thermal and Heat Management Testing
- Detailed, Component Reliability Analysis

## Spectra Certifications, Ratings, and Patents

- CE, Class B
- UL Listed
- UL Listed to Canadian Safety Standards
- Complies with Argentina Compliance Requirements Under Res. 92/98
- FCC, Class B
- U.S. Patents 5,931,432; 6,793,415 B2; 6,802,656 B2; 6,821,222 B2 Meets the Following Standards:
- NEMA Type 4X, IP66 when Installed Properly (BB4-F-E, BB4-PB, BB4-PG, and BB4-PG-E) NEMA Type 1, IP40 (BB4-SMW, BB4-SMB and BB4-F)

## Get More With Pelco

It all starts with a relentless commitment to Fanatical Customer Service. Each and every person at Pelco will stop at nothing to ensure that our customers are completely satisfied each and every time. Just ask anyone who has ever worked with us. Stringent design, engineering and testing certifications ensure that your next Pelco purchase will deliver the performance that you and your installation demand.



Fanatical Customer Service

## Pelco Service and Support

Committed to delivering service and support second to none, Pelco has established an impressive array of customer service programs to complement our industry-leading products and solutions. From Guaranteed Ship Dates, to Local Service Centers, to the Pelco Video Security Institute, Pelco is committed to your success. You're never on your own when you're with Pelco. Our network of Product Support professionals, Global Field Trainers and industry experts are available to assist you in any way necessary – 24 hours a day. Seven days a week. Three-Year, Continuous-Duty Warranty Pelco will repair or replace, without charge, any Spectra IV merchandise proved defective in material or workmanship for a period of three years after the date of shipment. For complete Pelco warranty details, visit: [www.pelco.com/support/warranty.aspx](http://www.pelco.com/support/warranty.aspx)



Unmatched Quality and Service

# Any Dome Drive Fits Any Back Box.



The Spectra IV series boasts the widest range of installation and dome drive options in the industry. From Indoor In-Ceiling Mounts and Outdoor Pendants to Impact Resistant and Pressurized models, Spectra IV has the model to meet your exact needs.



## 1 Surface-Mount Back Box

New surface-mount back box. An excellent choice for cost-effective indoor applications. Pendant adapter plate also available.

## 2 Environmental In-Ceiling

Environmental in-ceiling design for use in outdoor overhangs and soffits. Rated for -60°F to 140°F.

## 3 In-Ceiling Back Box

In-ceiling back box for use in suspended and hard ceilings where a discreet presence is of high importance.

## 4 Standard Pendant

Standard Pendant for use in indoor or outdoor moderate climates. Also available in black finish.

## 5 Environmental Pendant

Environmental Pendant, for use in the most extreme climate conditions, ranging from -60°F to 140°F.

## 6 Heavy-Duty Pendant

Heavy-duty Pendant for use in indoor and outdoor heavy traffic areas where vandalism is a concern. Available with or without protective cage.

## 7 Heavy-Duty In-Ceiling Back Box

Heavy-duty in-ceiling back box for use in indoor areas where vandalism is a concern. Available with or without protective cage.

## 8 Stainless Steel

All 316L stainless steel construction is designed to resist corrosion. Ideal for installation in all challenging environmental conditions, as it provides excellent external protection.

## 9 Pressurized

All 316L stainless steel construction and nitrogen pressurization protect camera, lens and system electronics from the most extreme environmental conditions.

## Performance Features

- Five Autofocus, High Resolution Integrated LowLight™ Camera/Optics Packages
- Zone Blanking
- Window Blanking
- Camera Title Overlay, 20 User Definable Characters
- On-Screen Compass and Tilt Display
- Password Protection
- Freeze Frame During Presets
- Built-in Surge and Limited Lightning Protection
- Integrated Passive UTP Circuit
- Internal Scheduling Clock
- Electronic Image Stabilization (35X Only)

## Installation Features

- 11 Back Box Models
- 19 Mounting Options
- Switchable 24 VAC or 24 VDC Operation
- Built-In Back Box Memory (SE Models)
- Integrated UTP Circuit
- RJ-45 Data Port for Software Update Setup
- Autosensing Protocol (Coaxitron; RS-422 P and D); Accepts Competitive Control Protocol with Optional TXB Translation Boards
- Built-In Menu System for Setup of Programmable Functions
- Compatible with Pelco FS85011 and Third-Party Fiber Optic Transmitters

# Modular Design. Ahead of Its Time.



Choose from five autofocus, high resolution integrated optics packages; eight back-box options; six lower domes; 19 mounting options; and 11 communications options. The most dynamic positioning system in the industry. Look to Spectra IV. The numbers really add up.

## Mount Options

- Wall Mount, Short
- Wall Mount, Long
- Wall Mount, Long with 24 VAC Transformer
- Corner Mount
- Pole Mount
- Wall Mount
- Stainless Steel, Long
- Wall Mount
- Stainless Steel, Short
- Parapet Wall Mount, Long
- Parapet Wall Mount, Short
- Ceiling/Pipe Mount
- Parapet Rooftop, Long
- Parapet Rooftop, Short
- Parapet Rooftop
- Heavy Duty
- Wall Mount Flat
- 2' x 2' Ceiling Tile

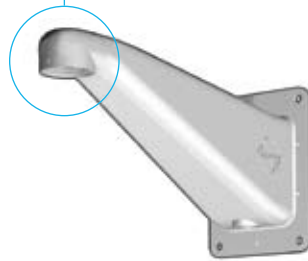

## Back Box Options

- Standard Pendant
- Environmental Pendant
- Surface-Mount
- In-Ceiling
- Environmental In-Ceiling Heavy-Duty Pendant
- Heavy-Duty Environmental Pendant
- Heavy-Duty In-Ceiling
- Stainless Steel
- Pressurized

## Communication Options

- Integrated UTP Circuit
- PelcoFiber Module (single-mode)
- PelcoFiber Module (multi-mode)
- TXB-IP
- NTCIP
- AD
- Bosch
- Sensormatic
- Vicon
- Hernis

## Dome Drive Options

- 16X Zoom Lens with LowLight Technology
- 18X Zoom Lens with Day/Night Camera, LowLight Technology
- 22X Zoom Lens with Color Camera, LowLight Technology
- 23X Zoom Lens with Day/Night Camera, Wide Dynamic Range and Motion Detection, LowLight Technology
- 35X Zoom Lens with Day/Night Camera, Wide Dynamic Range and Motion Detection, Electronic Image Stabilization, LowLight Technology
- DD5-FM Fixed Camera



## Lower Dome Options

- Smoked
- Clear
- Chrome
- Gold
- Heavy-Duty
- Heavy-Duty with Cage



by **Schneider** Electric

*The recognized worldwide leader in video and security systems, Pelco boasts the most comprehensive array of products, services and expertise available in today's marketplace. And now as a member of the Schneider Electric family, Pelco brings a network of assets backed by the strength of a Fortune 500 company to help you define and achieve your business objectives.*

[www.pelco.com](http://www.pelco.com)

Pelco Inc. Worldwide Headquarters 3500 Pelco Way Clovis, California 93612 USA  
(800) 289-9100 (800) 289-9150 Fax +1 (559) 292-1981 International +1 (559) 348-1120 International Fax

Worldwide Locations: Australia Canada Finland France Germany Italy Macau The Netherlands Russia  
Singapore South Africa Spain Sweden United Arab Emirates United Kingdom United States

Features and specifications subject to change without notice. ©Copyright 2008, Pelco. All rights reserved.



*This paper is FSC Certified, contains 10% post-consumer waste and is printed with soy ink.*

C-5029B - 07/08